

# Technical data sheet

## Clamp clip 2056 H-foot, 2-fold, metal pressure sleeve, A2

Item number: 1186163



Clamp clip with hammerhead foot, metal pressure sleeve with rounded edges to protect the cable. For vertical and horizontal mounting of 2 single cables on a C-profile rail. For a slot width 16–17 mm. With 1-start screw thread on pressure sleeve, universal hexagonal screw head WAF10, with slot and cross recess. Suitable for assembly indoors and outdoors. Multiple cables should be separated by double sleeves. We recommend the use of a counter-sleeve.



|    |                 |
|----|-----------------|
| A2 | Stainless steel |
| 2B | Bright, treated |

| Master data                        |                        |  |
|------------------------------------|------------------------|--|
| Item number                        | 1186163                |  |
| Type                               | BS-H2-M-64 A2          |  |
| Description 1                      | Clamp clip 2056        |  |
| Description 2                      | double                 |  |
| Manufacturer                       | OBO                    |  |
| Dimension                          | 58-64mm                |  |
| Material                           | Stainless steel        |  |
| Surface                            | Bright, treated        |  |
| Surface standard                   |                        |  |
| Smallest sales unit                | 15                     |  |
| Unit of quantity                   | Piece                  |  |
| Weight                             | 23.384 kg              |  |
| Weight unit                        | kg/100 pc.             |  |
| CO2 Footprint (GWP) Cradle-to-Gate | 1,182 kg COe / 1 Piece |  |

# Technical data sheet

Clamp clip 2056 H-foot, 2-fold, metal pressure sleeve, A2

Item number: 1186163



## Dimensions

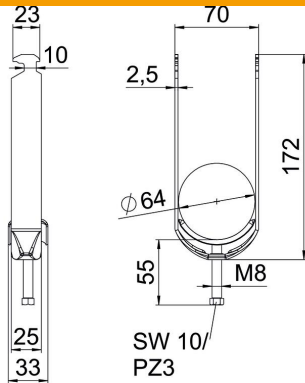

|                  |        |
|------------------|--------|
| Length           | 25 mm  |
| Width            | 70 mm  |
| Height           | 172 mm |
| Plate thickness  | 2.5 mm |
| Dimension A      | 25 mm  |
| Dimension B      | 70 mm  |
| Dimension C      | 33 mm  |
| Dimension G (mm) | M8     |
| Dimension H      | 172 mm |
| Dimension L      | 55 mm  |
| Dimension t      | 2.5 mm |

## Technical data

|  |                              |
|--|------------------------------|
| Number of cables/pipes                         | 2                            |
| For pipe diameter, max.                        | 64 mm                        |
| For pipe diameter, min.                        | 58 mm                        |
| for rail with slot width (with interval), max. | 17 mm                        |
| for rail with slot width (with interval), min. | 16 mm                        |
| Thread   | M8                           |
| Halogen-free                                   | yes                          |
| Length of external dimensions                  | 33 mm                        |
| Max. Tightening torque                         | 5 Nm                         |
| With plastic trough                            | no                           |
| With metal trough                              | yes                          |
| Mounting type                                  | Profile rail                 |
| Slot width                                     | 10 mm                        |
| Clamping range D, max.                         | 64 mm                        |
| Clamping range D, min.                         | 58 mm                        |
| Surface addition                               | Untreated                    |
| Material addition                              | Rustproof steel              |
| With counter-trough                            | no                           |
| Material of trough                             | Rustproof steel              |
| Material quality of trough                     | Stainless steel 304 (1.4301) |